

0.060" CLEAR ANODIZED
ALUM. CENTER PLATE
CONT. ALUM. EXPOSED EXTRUSION
CLEAR ANODIZED FINISH
FASTENER @ 18" O.C. MAX, BY INSTALLER
CONT. BASE EXTRUSION, MILL FINISH

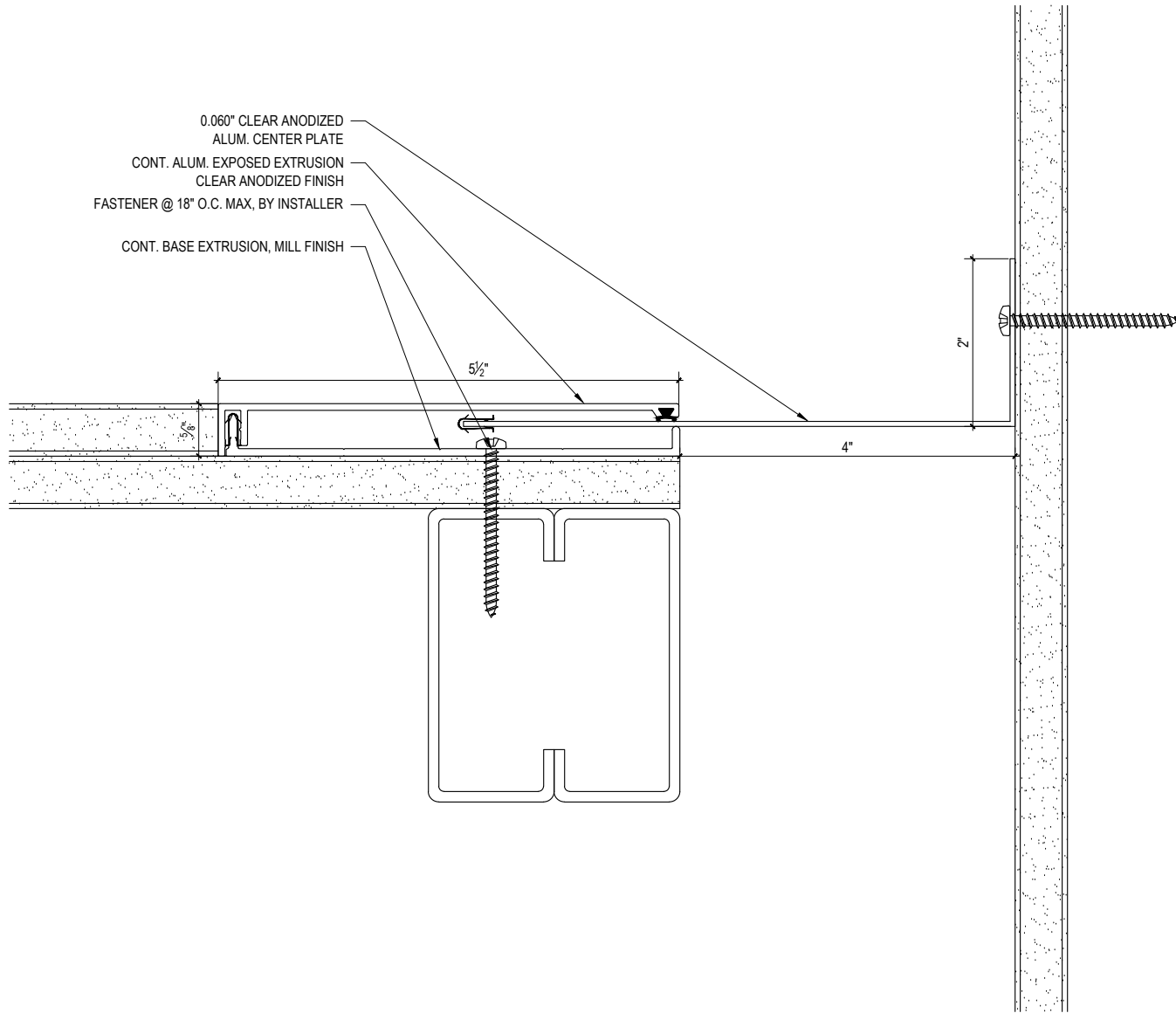

SCALE: 6"=1'-0"



M.H. POWELL & CO., INC.
ARCHITECTURAL SEISMIC EXPANSION JOINT SYSTEMS

2313 YATES AVENUE | PHONE : (323) 887-0037
COMMERCE, CA 90040 | FAX : (323) 887-0877
WEB : www.mhpowell.net

**MODEL
KFM-4-2.5**

WALL/CEILING CORNER EJC

PROJECT : _____ PROJECT # : _____
 LOCATION : _____ DATE : _____
 ARCHITECT : _____
 CUSTOMER : _____

PAGE #